

HORIZON III HORIZONTAL BEDHEAD UNIT

Architectural

arq

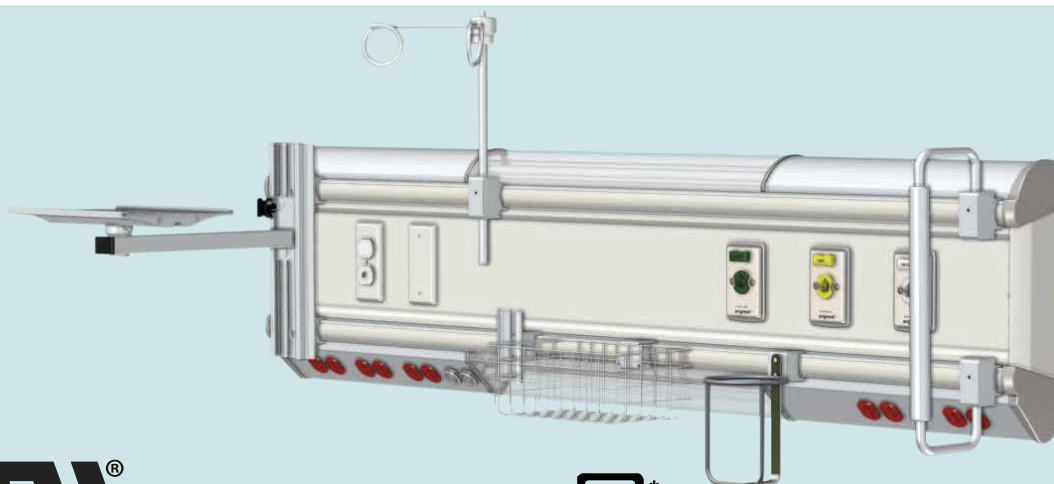

ARQ



2015 Edition



Structure

MATERIALS

● Structure:

Aluminium profile extrusion 6063 T5 alloy meeting ASTM B221-02 /AA. 4 internal channels and 1 back side open channel to medical gas, electrical, data and lighting. Solid state separation (not removable).

● Front, superior and inferior panels:

Aluminium profile extrusion 6063 T5 alloy meeting ASTM B221-02, 2mm thickness self supported to bedhead unit aluminium structure, fixing screw is not required.

● Support Rails to auxiliary equipment:

Aluminium extrude profile 6063 T5 alloy meeting ASTM B221-02, Service rails include on the equipment also mount devices to medical auxiliary equipment.

FINISHING

● Structure:

10 microns natural anodized or powder coating finish.

● Front Panel:

- 1) Aluminium extrusion profile powder coating finishing or wood imitation by sublimated process.
- 2) MDF wood panel back support 16mm thickness with plastic laminated decorative sheet 1mm thickness.

PATIENT LIGHTING

T8 LED tube 60cm length, 110-220v main power 60-50 hz, 4,300°k color light (day light/white) to environment and patient reading lighting.

Plastic extrusion transparent Polycarbonate diffusers self supported to horizontal bedhead unit aluminium structure.

Chain type light switch to environment lighting and switch button type to patient reading lighting.

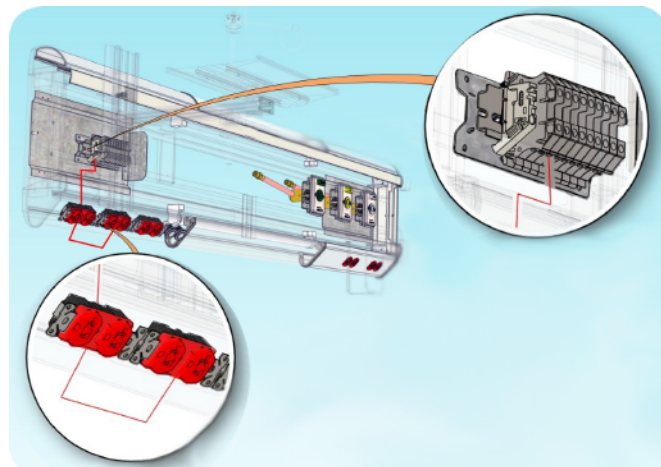

*** Installation must be performed by medical gas certified personnel***

GRUPO ARIGMED S. DE R.L. DE C.V. TIZAYUCA, ESTADO DE HIDALGO, MÉXICO

www.arigmed.com Arigmed Medical Gas Equipments ventasmx@arigmed.com +52 779 79 69 370



CERTIFIED



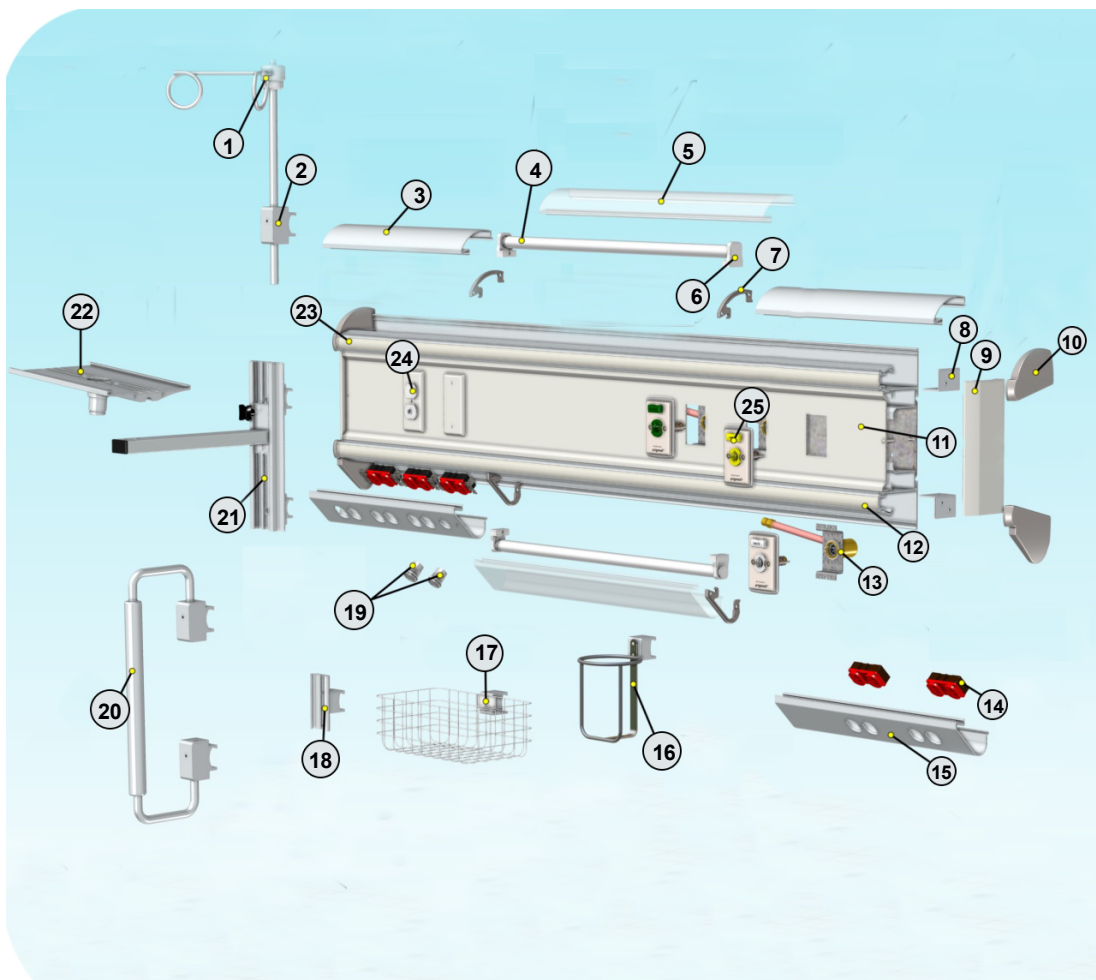

Item:	Description:
1	Venocllisis support
2	Horizontal support-slide device
3	Up aluminum panel self supported
4	T8 Led lamp
5	Ligthing difusser
6	Led lamp socket
7	Plastic injection adjust join piece
8	Aluminium structure
9	Aluminium structure end cap
10	Plastic injection end cap
11	Aluminium front panel screw fixed
12	Horizontal service rail
13	Medical gas outlet back assembly
14	Electrical outlet
15	Aluminium panel self supported
16	Canastilla portafrasco de 1L
17	Vacuum bottle support
18	Slide support
19	Button type electrical Switch patient ligthing
20	Bar type infusion pump support inox or aluminium
21	Vertical Service Rail
22	Patient monitor shelf type support
23	Horizontal Service Rail
24	RJ45 outlet
25	Medical Gas outlet front assembly

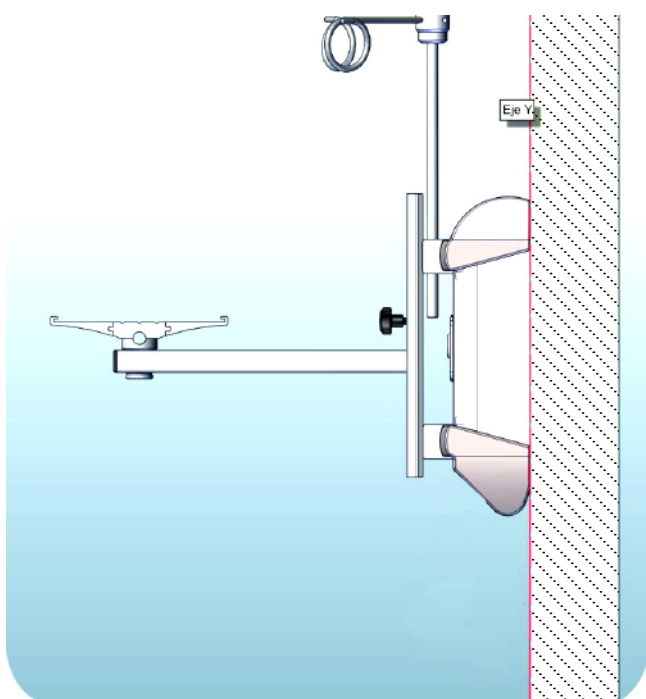

ELECTRICAL OUTLETS

It can accept all kinds of electrical outlets models according with local or international electric codes.

MEDICAL GAS AND VACUUM INLET-OUTLETS

Mounted on the front panel, it can include a pre-assemble rigid type K copper pipe (customer must be specify). Horizontal bedhead unit can allow the assembly of any kind of medical gas outlet.

Complies with NFPA99-2015 exclusively with systems and devices of electrical, ligh and medical gases that have been assembled from factory origin.

In the case the horizontal bedhead unit has been supplied partially or modified in the components and systems of factory origin, we disclaim any resoponsibility for risk and injuries and damages to people and properties.