

## Structure

### MATERIALS

#### Structure:

Aluminium profile extrusion 6063 T5 alloy meeting ASTM B221-02/AA. Front isolated open panel channels to medical gas, electrical, data and lighting devices. Galvanized steel pipe to all wiring systems (electrical, voice, data, etc.).

### FINISHING

#### Structure:

10 microns natural anodized.

#### Removable Front Panels:

- 1) Aluminium sheet powder coating finishing or wood imitation by sublimated process.
- 2) MDF wood panel back support 16mm thickness with plastic laminated decorative sheet 1mm thickness. (Formica, Ralph Wilson, Nevamar covers).
- 3) MDF wood panel back support 16mm thickness with child's decorative front panel, laser color print over plastic acrylic sheet 3mm thickness, polyvinyl flexible plastic cap edges to wood back panel support.
- 4) To other materials or dimensions, consult to the factory.

### PATIENT LIGHTING

T8 LED tube 60cm length, 110-220v main power 60-50 hz, 4,300°k color light (day light/white) to environment and patient reading lighting.

Plastic extrusion transparent Polycarbonate diffusers self supported to patient Light lamp aluminium structure.

Chain type light switch to environment lighting and switch button type to patient reading lighting.

2 options to patient light, Aurora or Movita models available, aluminium extrusion profile alloy 6063 T5 made, 10 microns anodized finishing.

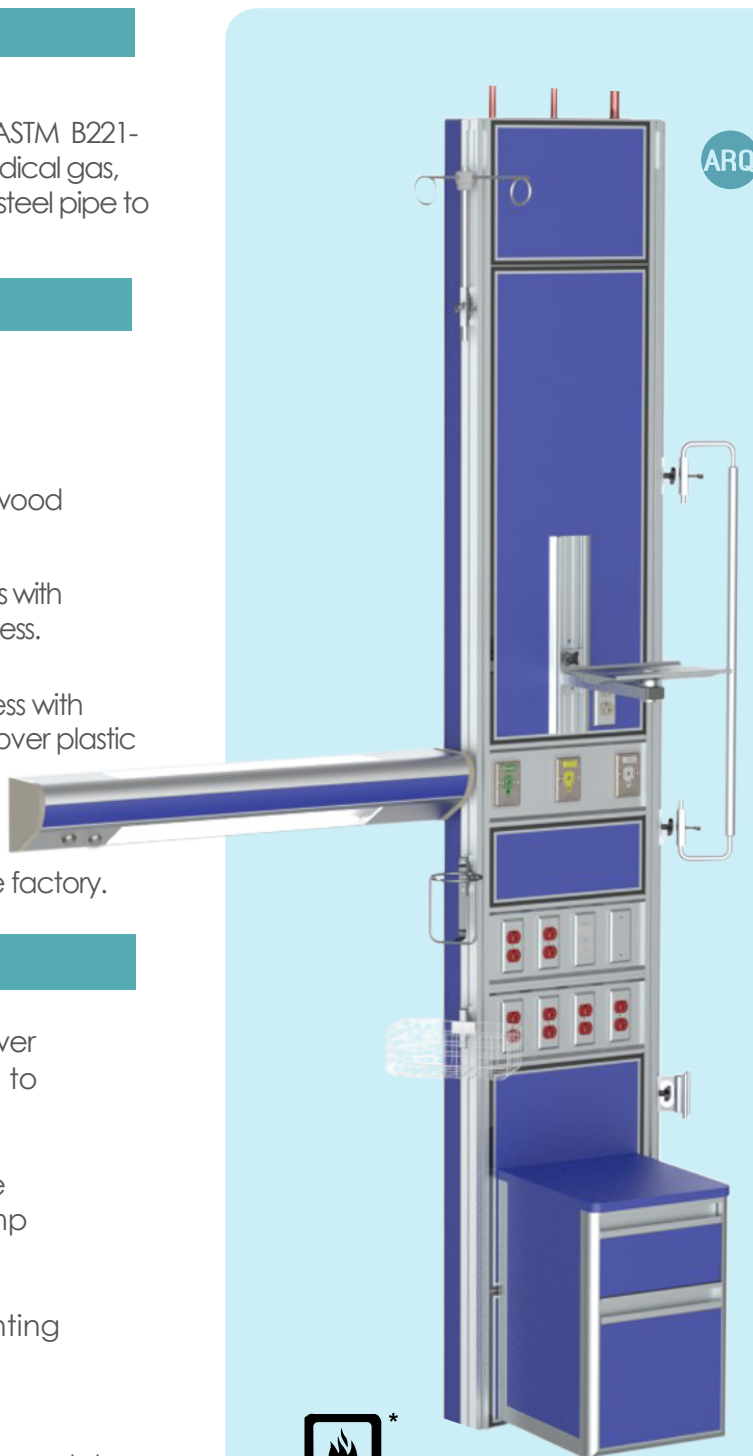

\*\*\* Installation must be performed by medical gas certified personnel\*\*\*

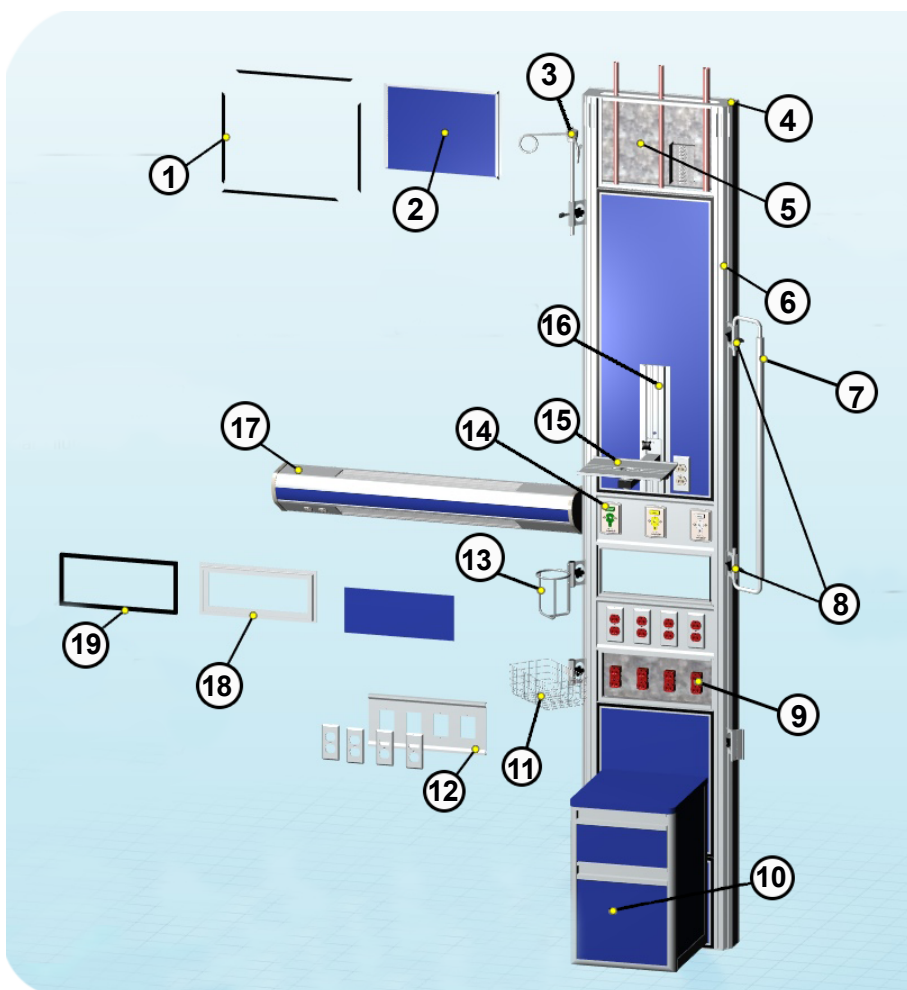

Item:	Description:
1	Plastic extrusion profile cover
2	Removable front panel
3	I.V support
4	Top cover (non removable)
5	Back cover (galvanized steel sheet)
6	Aluminium Structure
7	Infusion Pump Support
8	Accessories rail support device
9	Electrical Outlet
10	Guard
11	Medical basket
12	Aluminium panel
13	Vacuum bottle support
14	Medical gas Outlet
15	Patient monitor shelf type support
16	Vertical Service Rail
17	Patient Ligth
18	Aluminium profile (panel fixed)
19	Plastic extrsuion profile cover

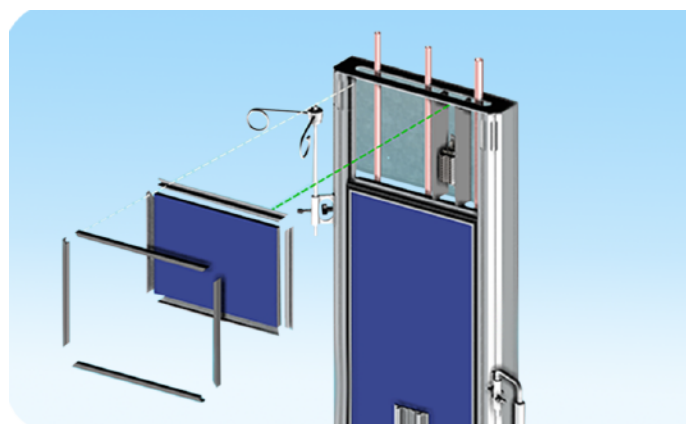

## VERTICAL SERVICE RAILS (SUPPORT AND SLIDE)

Vertical column bedhead unit includes service rails (3 rails by each side of column) to support and slide of medical auxiliary equipment.

## ELECTRICAL OUTLETS

It can accept all kinds of electrical outlets models according with local or international electric codes.

## MEDICAL GAS AND VACUUM INLET-OUTLETS

Mounted on the front panel, it can include a pre-assemble rigid type K copper pipe (customer must be specify). vertical bedhead unit can allow the assembly of any kind of medical gas outlet.

Complies with NFPA99-2015 exclusively with systems and devices of electrical, ligh and medical gases that have been assembled from factory origin.

In the case the vertical bedhead unit has been supplied partially or modified in the components and systems of factory origin, we disclaim any resoponsibility for risk and injuries and damages to people and properties.